



The PS-EFP system is designed to provide most cost-effective solution of power and data connection such as video and communication between the camera and the CCU with standard single-mode optical fiber which can be up to 10km.

When combined with the PS-EFP-B base station adapter and PS-EFP-C camera adapter, cameras can be remotely deployed using the ordinary single-mode optical fiber network that may exist within a stadium, campus or other outside broadcast.

Features

- Eliminate interference and grounding problems, saving the weight and cost of laying cables
- Use ordinary fiber optic connectors to connect cameras and CCUs through existing fiber optic infrastructure, or temporary field fiber optic cables
- The system supports the standard camera power supply protocol, which enables the camera and the CCU to activate of the optical transceiver inside, and establish a real connection between them with ordinary single-mode optical fiber
- The power supply unit can supply power to the camera through a standard SMPTE cable up to 1 km, and the power can meet the 4K and HD cameras installed with box lenses and other high-power accessories
- It can keep the ENG call function when the optical fiber is kept connected, while the camera is powered off and the CCU is powered on

System Configuration

Configuration 1

Camera powered by SMPTE cable

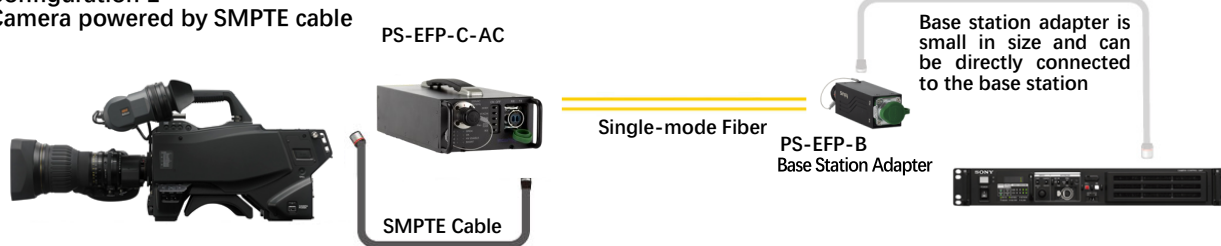

Configuration 2

Camera powered locally

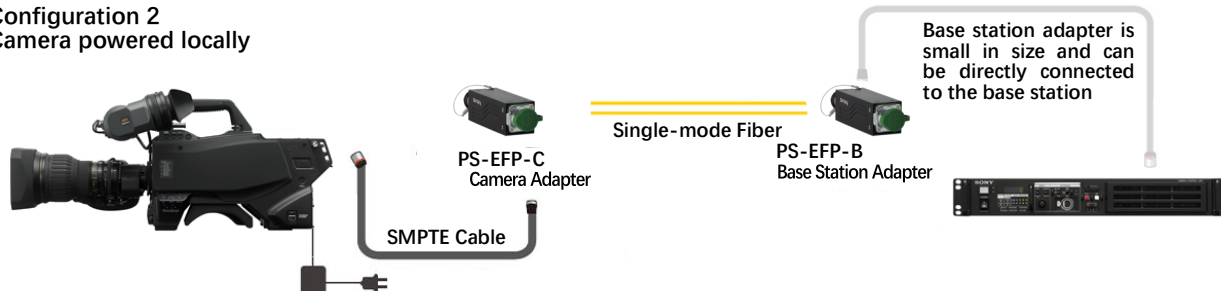

System Configuration

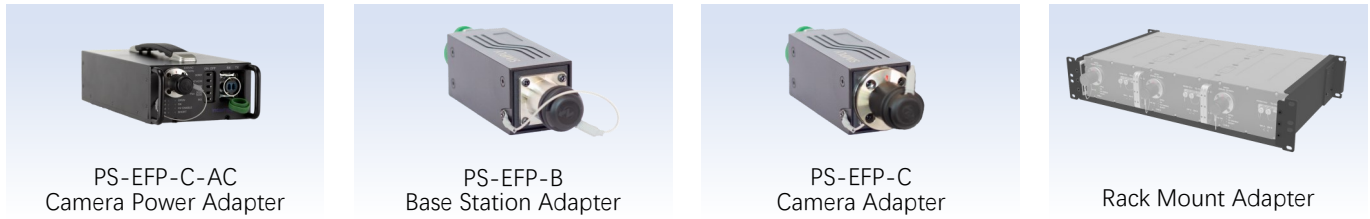

Technical Specifications

General	
Dimension / Weight	PS-EFP-C-AC: 272×145×85mm, Approx. 4.5kg PS-EFP-B: 150×40×40mm, Approx. 0.6kg PS-EFP-C: 154×40×40mm, Approx. 0.6kg
Operating temperature	-20°C to +70°C
Operating humidity	0 to 95%
Power consumption	AC 220/110V±10%, 50/60Hz, 25W (PS-EFP-C-AC)
Connectors	
Hybrid optic	SMPTE 304M, optional Tajimi OPS)
Single-mode optic	LC, optional ST, FC, SC
Carrier Signal	
Camera side	Camera to CCU: Video, Audio (Mic/Line), Intercom
CCU side	CCU to Camera: Return video, Promoter video, Audio (PGM), Intercom
Compatible Model	
Model	SONY: HDC-1580, HDC-2580, HDC-4300, HDC-4800, HDC-3500, HDC-5500 Panasonic: AK-HC3500, AK-HC3800, AK-HC5000, AK-UC4000

Design and specifications are subject to change without notice.

Dimensions

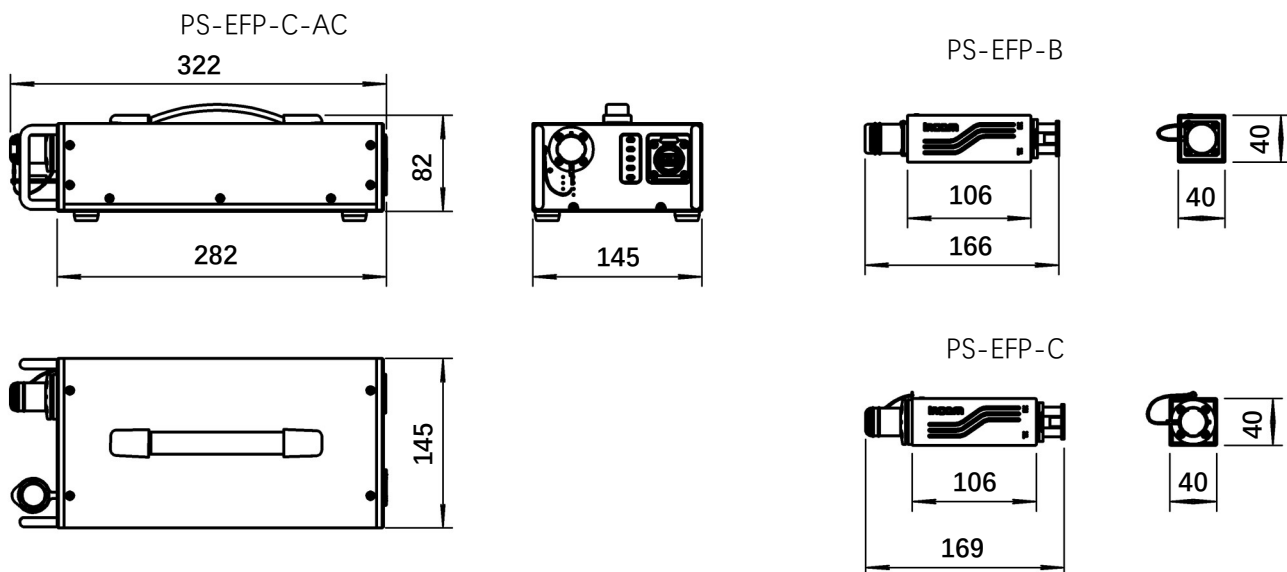

INCAM Systems Co., Ltd.

Building B6, North Park, No.315 Xiqing Road, Yangliuqing Town, Xiqing District, Tianjin, China

